

NY Thermal Inc.
 Tel: (506) 657-6000
 Toll Free: 1-800-688-2575
 Fax: 1-506-432-1135
 Web: www.nythermal.com
 Email: info@nythermal.com

Installation Instructions for Blower Support Kit GF 200 Furnace



This boiler must be serviced by a qualified heating technician. Failure to properly maintain or service this appliance may result in property damage, serious injury to occupants or, death.



The installation of this kit must be performed by a qualified boiler technician. Installing this kit without the proper qualifications and training is hazardous and may result in property damage or death.

Applicable boiler: GF200 Serial No. 96830 and earlier

Kit Contains:

1. Main bracket
2. Top plate
3. Bottom support bracket (front w/ nutserts).
4. Bottom support bracket (rear).
5. Bolt 9" x 3/8" (x 2)
 - a. Threaded rod – 9" x 3/8" (x 2)
 - b. Nut – 3/8" (x 4)
6. Washer – 3/8 (x 2)
7. Bolt - 1/4" – 20, 1/2" (x 2)
8. Nut – Nyloc, 1/4" – 20 (x 2)
9. Screw – Self-drilling, 1/4 -14 x 3/4" (x 2)
10. Screw – Phillips, #10-24. 1/2" (x 3)
11. Washers - 3/16" (x 3)
12. Lock-tite – tube, 0.5 ml (x2)

Tools Required:

1. Drill
2. Socket wrench (w/ extensions)
3. 9/16" or 5/8" Socket.
4. 7/16" Wrench.
5. Philips screw driver.
6. 1/4" Nut driver bit.
7. 3/8" Nut driver bit.

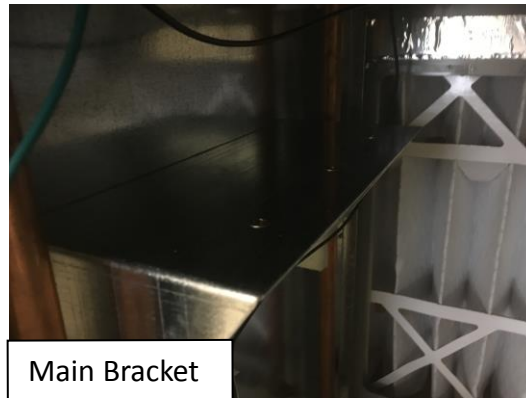

Main Bracket



Top Plate

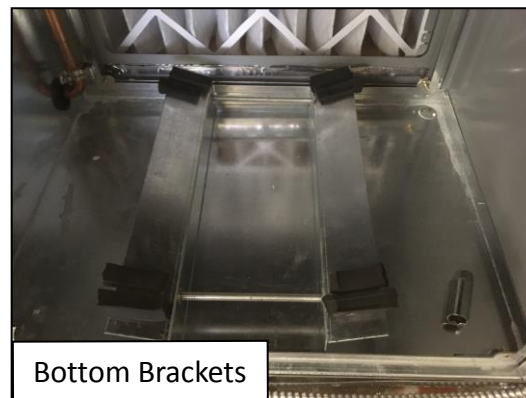

Bottom Brackets

Disassembly Instructions:

1) Remove side door of furnace to access the blower motor.

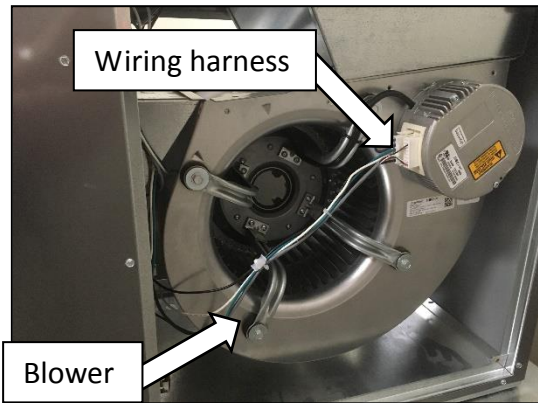

2) Unplug the two harnesses from the blower motor.

3) Remove the blower motor from the furnace.

4) Remove the Blower Shelf from inside the furnace and install the new Main bracket reusing the four (4) sheet metal screws that held the old part in place.

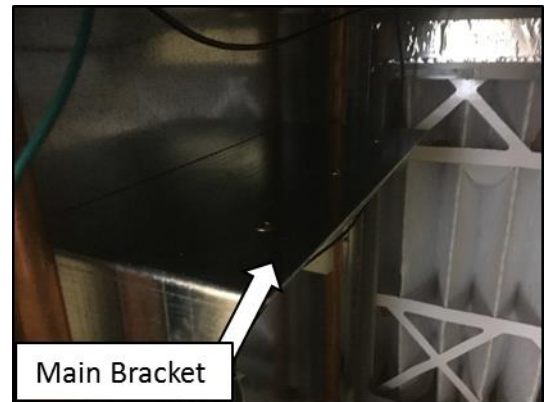

Installation Instruction:

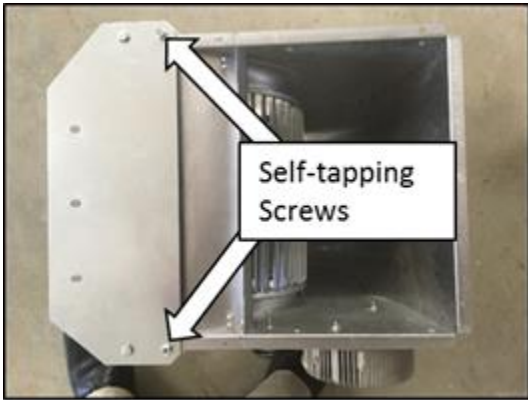

2) Install the Top Plate on the blower.

Note: The blower is offset by 1/2" within the cabinet due to the motor control module.

- a) The hole closest to the side goes to the right hand side of the blower (nearest the control module).
- b) Use the supplied bolts and Nyloc nuts in the existing holes; use the self-tapping screws as shown in the photo.

3) Assemble the Bottom Brackets:

- a) Slide a 9" bolt through a washer, then through the rear Bottom bracket, and thread it into the Nutsert in the Front Bottom Bracket until the bolt extends just beyond the Nutsert.
- b) Place the assembly on the bottom of furnace, as shown.

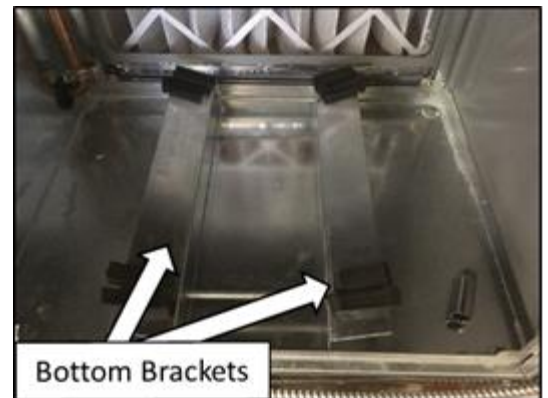

4) Replace the blower.

- a) Ensure the Top Plate slides over the new Main Plate.
- b) Ensure the Bottom Brackets are centered under the blower.

5) Adjust the blower and insert three (3) Philips head screws (w/washers) to join the Top Plate and the Main Bracket (hand tighten at first: tighten fully during/after step 6).

NOTICE

Ensure the heads of the bolts are to the rear of the furnace to allow maximum working room when tightening.

6) Tighten the bolts in the Bottom Brackets until the brackets are pressing the bottom of the blower firmly up into the galvanized structure above, adjusting the blower manually as required.

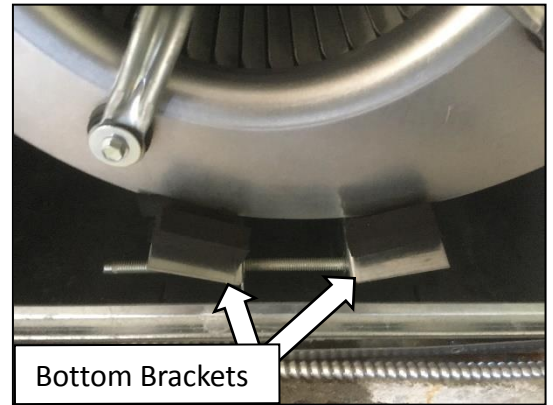

View of completed installation.